

Courtside Villas I HVAC Stands

All HVAC condensing units or “heat pumps” must be approved by the Board PRIOR to placement on HVAC stands. In the event of an emergency need for replacement taking place on weekends and Holidays, applications and deposits must be submitted immediately the following business day.

Replacement Guidelines for HVAC condensing units placed on HVAC stands on sides of buildings are as follows:

- Each owner has a unique and specific location for placement of the unit and its corresponding disconnect box. This will be outlined on the approval as well as marked on the HVAC stand. Strict adherence to this placement will be enforced. Any violation will be solely at the expense of the owner.
- Upon submittal for approval, the owner will be charged and invoiced a **\$250** refundable deposit will be required payable to Courtside Villas I, to be used in the event of any damage done to the common area or HVAC stand. An onsite inspection will be done by the Association Manager prior to deposit refund.
- All HVAC condensing units and accompanying connecting materials will meet or exceed all Charleston County codes.
- All contractors performing the work must be licensed with Charleston County, have all appropriate permits in hand and proof of insurance must be provided to the association prior to installation.
- Removal of damaged/ old unit must be in compliance with all Charleston County and Town of Seabrook codes and regulations.
- All disconnected and unused electrical and refrigerant lines must be removed completely from all visible areas of the underside of the building and in parking areas.
- New electrical and refrigerant lines must be enclosed in conduit to prohibit excessive condensation leaking onto the concrete and parking area.

Each Owner has an HVAC unit location that is specific to that Address Number based on the proximity to the access lines. HVAC unit size based on standard 36" square. Placement guidelines will be strictly enforced.

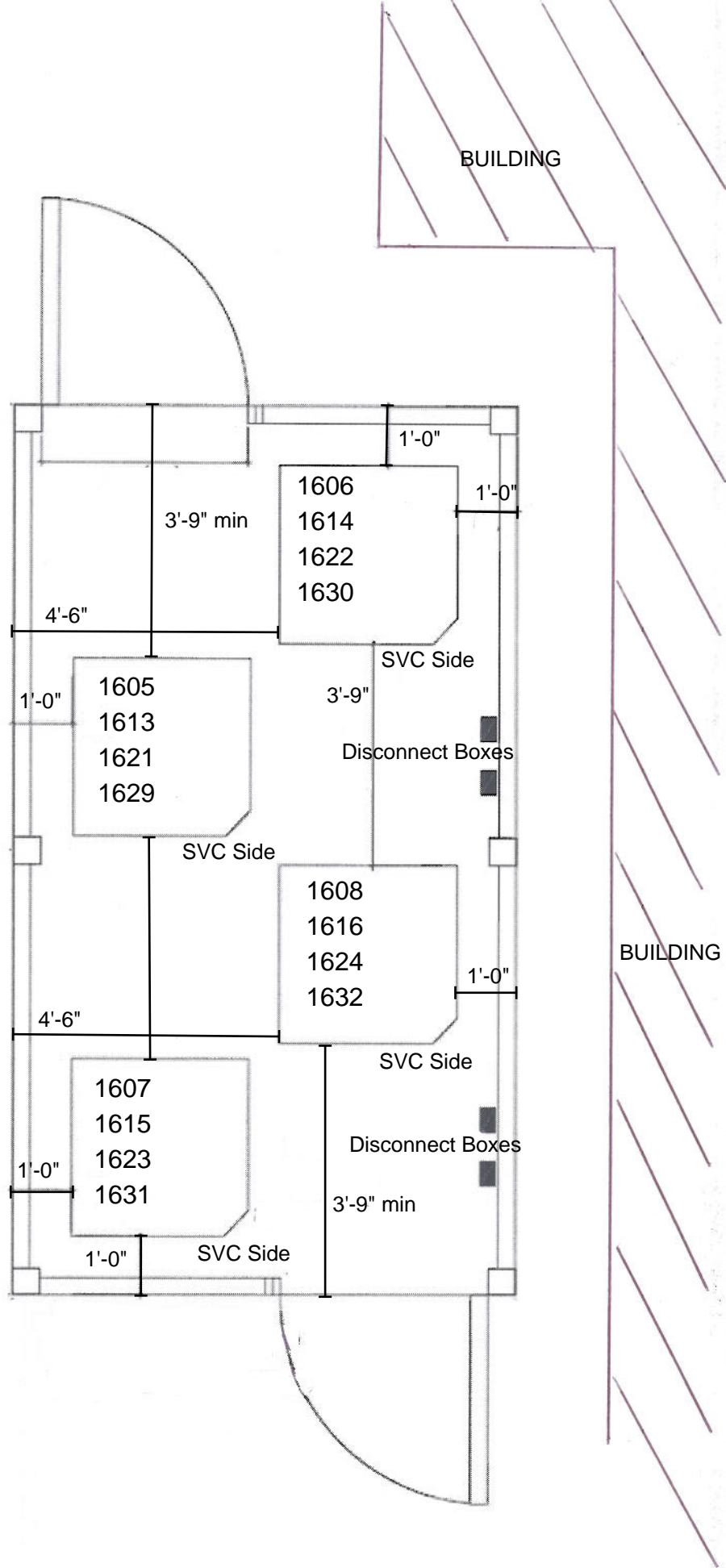

BUILDING

BUILDING

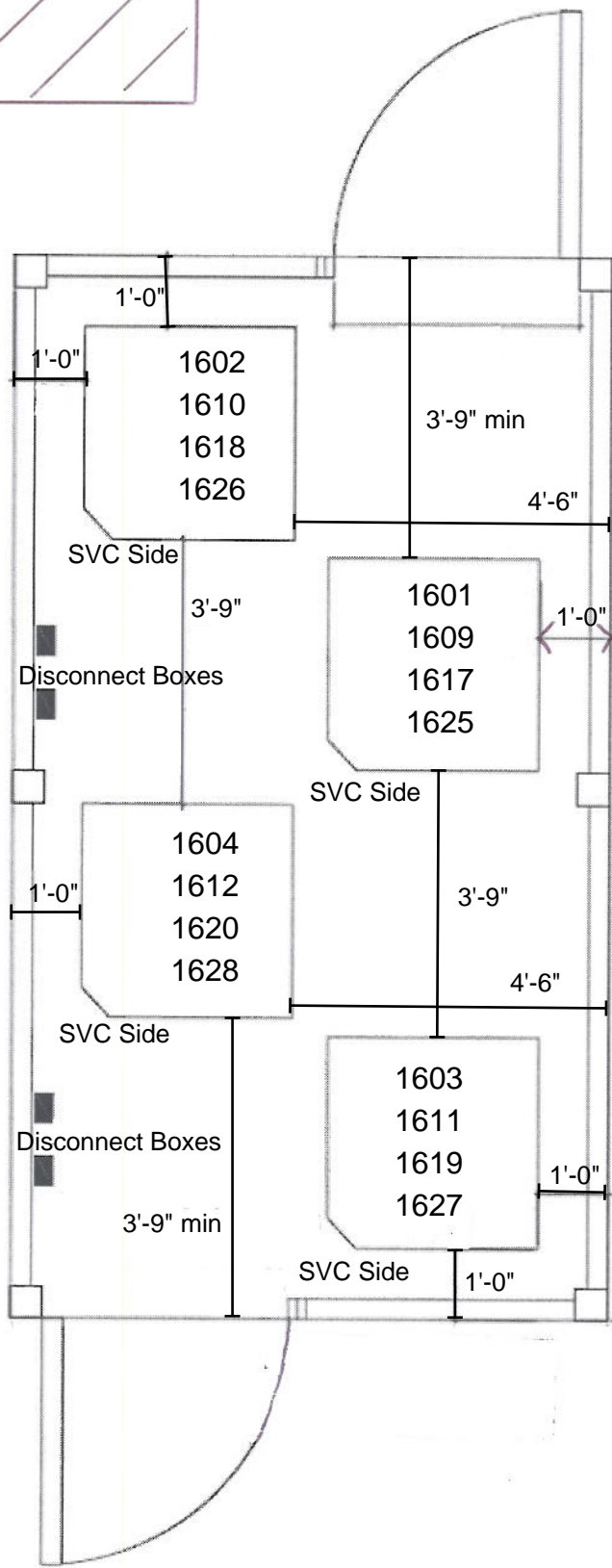

Each Owner has an HVAC unit location that is specific to that Address Number based on the proximity to the access lines. HVAC unit size based on standard 36" square. Placement guidelines will be strictly enforced.